

Jonsered

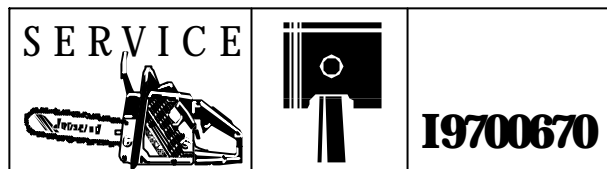

IPL, Service Tools, 1997

Not available as printed IPL

Service Tools

Chain Saws

2036, 2040

2041, 2045, 2050

2054, 2055

625, 630, 670

2077, 2083

2095



Oil pump

Generator

Model



530 03 11-36

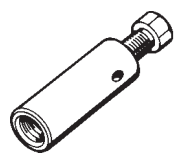

505 38 18-17

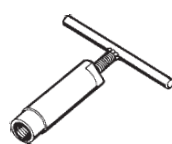

502 71 26-01



502 54 09-01

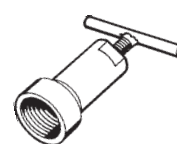

502 71 35-01



502 71 23-01

2036	●	-	-	-	-	-
2040	●	-	-	-	-	-
2041	-	●	-	-	-	-
2045	-	●	-	-	-	-
2050	-	●	-	-	-	-
2051	-	-	●	-	-	●
2054	-	-	●	-	-	-
2055	-	-	●	-	-	●
625	-	-	-	-	-	-
630	-	-	-	-	-	-
670	-	-	-	-	-	-
2077	-	-	-	●	-	-
2083	-	-	-	-	-	-
2094	-	-	-	-	●	-
2095	-	-	-	-	-	-



Clutch

Vibration damper

Model



502 54 04-01

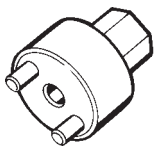

530 03 11-12

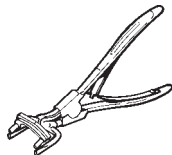

502 50 49-01

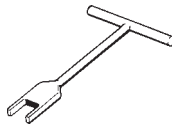

18 mm

502 50 66-02

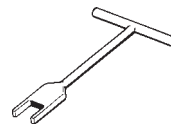

11 mm

502 50 67-01

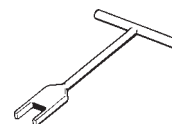

14 mm

502 51 00-02

2036	—	●	—	—	—	—
2040	—	●	—	—	—	—
2041	—	—	—	—	—	—
2045	—	—	—	—	—	—
2050	—	—	—	—	—	—
2051	—	—	—	—	—	—
2054	—	—	—	—	—	—
2055	—	—	—	—	—	—
625	—	—	●	●	●	●
630	—	—	—	●	●	●
670	—	—	—	●	●	●
2077	●	—	●	●	—	—
2083	—	—	—	—	—	—
2094	—	—	—	●	—	—
2095	—	—	—	—	—	—



Crankshaft

Ball bearing

Model

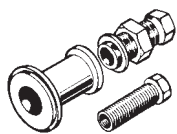

502 50 30-04

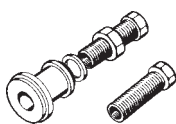

502 50 30-08

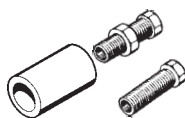

502 50 30-09

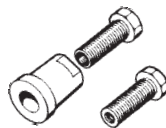

502 50 30-13

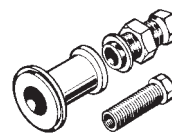

502 50 30-14

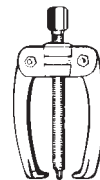

504 90 90-01

2036	—	—	—	—	—	●
2040	—	—	—	—	—	●
2041	—	—	●	—	—	●
2045	—	—	●	—	—	●
2050	—	—	●	—	—	●
2051	—	—	—	—	—	●
2054	—	—	—	—	—	●
2055	—	—	—	—	—	●
625	●	—	—	—	—	●
630	●	—	—	—	—	●
670	●	—	—	—	—	●
2077	—	—	—	●	—	●
2083	—	—	—	—	●	●
2094	—	●	—	—	—	●
2095	—	●	—	—	—	●



Sealing ring

Model

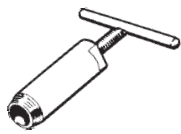

504 91 40-01



502 50 55-01

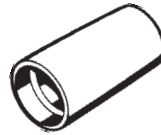

502 50 53-01

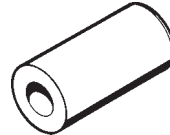

504 91 28-00

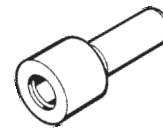

504 91 28-06

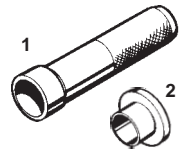

¹505 38 17-09
²505 38 17-39

2036	—	—	—	—	—	—
2040	—	—	—	—	—	—
2041	—	—	—	—	—	●
2045	—	—	—	—	—	●
2050	—	—	—	—	—	●
2051	●	—	—	●	—	—
2054	●	—	—	●	—	—
2055	●	—	—	●	—	—
625	●	—	●	—	●	●
630	●	—	●	—	●	●
670	●	—	●	—	●	●
2077	●	●	—	—	—	●
2083	●	●	—	—	—	●
2094	●	●	—	●	—	●
2095	●	●	—	●	—	●



Cylinder and piston

Ignition system

Model

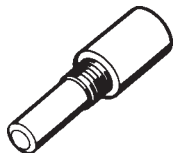

502 50 33-01



504 91 06-05

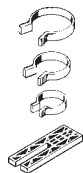

502 50 70-01

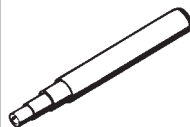

505 38 17-05

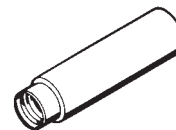

502 51 94-01

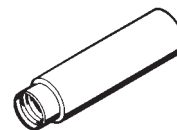

504 91 08-07

2036	●	—	●	●	●	—
2040	●	—	●	●	●	—
2041	●	—	●	●	—	●
2045	●	—	●	●	—	●
2050	●	—	●	●	—	●
2051	—	●	●	●	—	—
2054	—	●	●	●	—	—
2055	—	●	●	●	—	—
625	●	—	●	●	—	—
630	●	—	●	●	—	—
670	●	—	●	●	—	—
2077	●	—	●	●	—	—
2083	●	—	●	●	—	—
2094	●	—	●	●	—	—
2095	●	—	●	●	—	—



Ignition system

Crankcase

Model

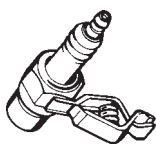

502 71 13-01

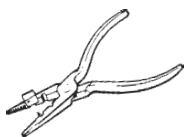

502 50 06-01

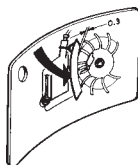

502 51 34-05

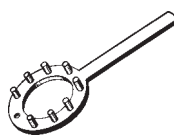

504 91 08-03

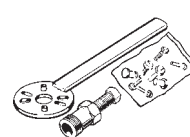

502 51 49-01

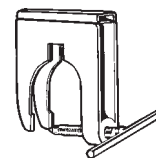

502 51 61-01

2036	●	●	●	—	—	—
2040	●	●	●	—	—	—
2041	●	●	●	—	—	—
2045	●	●	●	—	—	—
2050	●	●	●	—	—	—
2051	●	●	●	●	—	—
2054	●	●	●	●	—	—
2055	●	●	●	●	—	—
625	●	●	●	●	●	●
630	●	●	●	●	●	●
670	●	●	●	●	●	●
2077	●	●	●	●	●	●
2083	●	●	●	●	●	●
2094	●	●	●	●	●	●
2095	●	●	●	●	●	●



Tightness testing

Chain brake

Fuel pick-up

Model

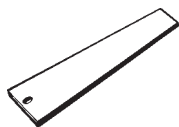

502 54 11-01

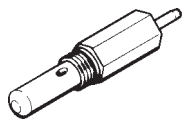

503 84 40-01

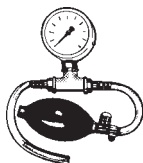

502 50 38-01

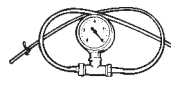

502 50 37-01

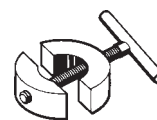

502 71 30-01



502 50 83-01

2036



—



2040



—



2041



2045



2050



2051



2054



2055



625



—



630



—



670



—



2077



—



2083



—



2094



—



2095





—



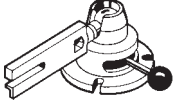
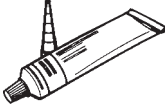

Workshop equipment

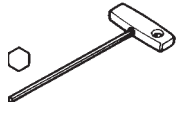
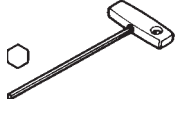
Model	 502 71 14-01	 502 51 02-01	 503 26 70-01	 504 90 00-01-04 + 505 38 13-08 = 504 90 00-06	 3/16" 502 50 57-01	 3 mm 504 90 00-04
2036	●	●	●	●	-	-
2040	●	●	●	●	-	-
2041	●	●	●	●	-	-
2045	●	●	●	●	-	-
2050	●	●	●	●	-	-
2051	●	●	●	●	-	-
2054	●	●	●	●	-	-
2055	●	●	●	●	-	-
625	●	●	●	●	●	●
630	●	●	●	●	●	●
670	●	●	●	●	●	●
2077	●	●	●	●	-	-
2083	●	●	●	●	-	●
2094	●	●	●	●	-	-
2095	●	●	●	●	●	-

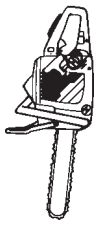

Workshop equipment

Model

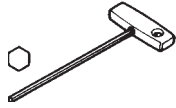

4 mm

504 90 00-02

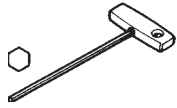

5 mm

504 90 00-03

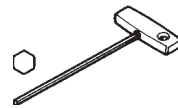

6 mm

504 90 00-01

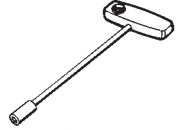

8 mm

505 38 13-08

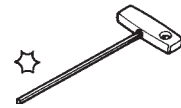

25 x 150

502 71 27-01

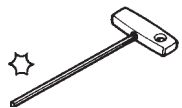

30 x 200

502 71 31-01

2036	●	—	—	●	—	—
2040	●	—	—	●	—	—
2041	●	—	—	●	●	—
2045	●	—	—	●	●	—
2050	●	—	—	●	●	—
2051	●	—	—	●	●	—
2054	●	—	—	●	—	—
2055	●	—	—	●	—	—
625	●	●	—	●	—	—
630	●	●	—	●	—	—
670	●	●	—	●	—	—
2077	—	—	—	●	●	●
2083	●	●	—	●	●	●
2094	●	●	—	●	●	●
2095	●	●	—	●	—	—



Workshop equipment

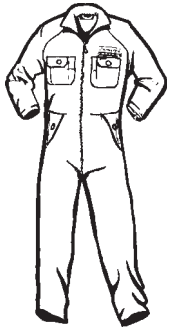

Model

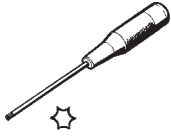

502 51 67-01

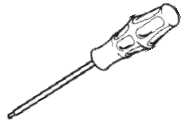

M6

502 50 88-01

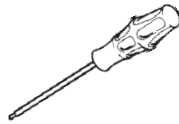

M5

502 50 87-01

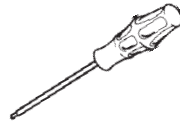

M4

502 50 86-01

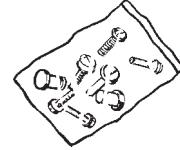

502 51 54-01

Size 46: 108 07 21 46
48: 108 07 21 48
50: 108 07 21 50
52: 108 07 21 52
54: 108 07 21 54
56: 108 07 21 56
58: 108 07 21 58

2036	-	-	-	●	-	●
2040	-	-	-	●	-	●
2041	-	-	-	●	-	●
2045	-	-	-	●	-	●
2050	-	-	-	●	-	●
2051	-	-	-	●	-	●
2054	-	-	-	●	-	●
2055	-	-	-	●	-	●
625	-	-	●	●	●	●
630	-	-	●	●	●	●
670	-	-	●	●	●	●
2077	●	-	-	-	●	●
2083	●	-	●	●	●	●
2094	●	-	●	●	●	●
2095	●	-	●	●	●	●

Technical Data	2036	2040	2041	2045	2050	2054	2055	625	630	670	2077	2083	2095
Capacity, cm³	36.3	40.2	40.2	44.3	48.7	53.2	53.2	61.5	61.5	66.8	76.5	82.4	93.6
Cylinder diam., mm	38.0	40.0	40.0	42.0	44.0	46.0	46.0	48.0	48.0	50.0	52.0	54.0	56.0
Stroke length, mm	32.0	32.0	32.0	32.0	32.0	32.0	32.0	34.0	34.0	34.0	36.0	36.0	38.0
Compression ratio	8.0	8.0	10.5	10.5	10.5	10.5	10.5	10.1	10.5	10.5	10.1	10.1	10.0
Revs at max. power, rpm	8500	8500	9000	9000	9000	9300	9600	9000	8800	10000	9600	10000	8200
Max. rpm	13000	13000	12500	12500	12500	13000	14500	12500	13000	13500	13500	13500	13000
Idling speed, rpm	3000	3000	2500	2500	2500	2400	2400	2700	2700	2700	2800	2800	2400
Clutch engagement speed, rpm	4500	4500	3600	3600	3600	3500	3500	3700	3700	3700	3500	3500	3200
Ignition system, type	CD	CD	CD	CD	CD	CD	CD	CD	CD	CD	CD	CD	CD
Ignition system, manufacture	Phelon	Phelon	Phelon	Phelon	Phelon	EM	EM	EM	EM	EM	EM	EM	EM
Plug, Champion	RCJ7Y	RCJ7Y	RCJ7Y	RCJ7Y	RCJ7Y	RCJ7Y	RCJ7Y	RCJ7Y	RCJ7Y	RCJ7Y	RCJ7Y	RCJ6Y	RCJ6Y
Plug, NGK	BPMR7A	BPMR7A	BPMR7A	BPMR7A	BPMR7A	BPMR7A	BPMR7A	BPMR7A	BPMR7A	BPMR7A	BPMR7A	BPMR7A	BPMR7A
Electrode gap, mm	0.5	0.5	0.5	0.5	0.5	0.5	0.5	0.5	0.5	0.5	0.7	0.7	0.7
Distance flywheel/ignition module, mm	0.3	0.3	0.3	0.3	0.3	0.3	0.3	0.3	0.3	0.3	0.3	0.3	0.3
Carburettor, manufacture	Walbro	Walbro	Zama	Zama	Zama	Walbro	Walbro	Tillotson	Tillotson	Tillotson	Walbro	Walbro	Tillotson
Carburettor, type	WT289	WT289	CIQ-EL1	CIQ-EL1	CIQ-EL1	HDA119A	HDA119A	HS237A	HS256A	230D	WJ28B	WJ28B	265A
Carburettor setting, H/L	2.0/2.0	2.0/2.0	1.0/1.0	1.0/1.0	1.0/1.0	1.0/1 1/4	1.0/1 1/4	1.0/1.0	1.0/1.0	1.0/1.0	1.0/1.0	1.0/1.0	1.0/1.0
Fuel tank, litres	0.40	0.40	0.50	0.50	0.50	0.56	0.56	0.73	0.73	0.73	0.85	0.85	0.90
Oil tank, litres	0.20	0.20	0.25	0.25	0.25	0.38	0.38	0.40	0.40	0.40	0.40	0.40	0.70
Oil pump capacity at 6000 rpm, ml/min	7.0	7.0	6.0	6.0	6.0	3.0–7.0	3.0–7.0	3.5,7.0 9.0,13.0	3.5, 7.0 9.0, 13.0	3.5, 7.0 9.0, 13.0	4.0–20.0	4.0–20.0	9.0–22.0
Chain gear, number of cogs			7	7	7								
Chain pitch, inches	.325	.325	.325	.325	.325	.325 3/8	.325 3/8	3/8	3/8	3/8	3/8	3/8	3/8
Bar length, inches	13–16	13–16	13–18	13–18	13–18	13–18	13–18	15–24	15–24	15–24	15–24	15–28	15–28
Bar length, cm	33–41	33–41	33–46	33–46	33–46	33–46	33–46	38–61	38–61	38–61	38–61	38–71	38–71
Chain speed at max. power, m/s	15.5	16.3	17.3	17.3	17.3	18.0	18.5	22.9	24.4	24.4	24.4	21.3	21.5
Tightening torque, Nm													
Plug	20–22	20–22	20–22	20–22	20–22	20–22	20–22	20–22	20–22	20–22	20–22	20–22	20–22
Clutch	30–35	30–35	30–35	30–35	30–35	30–35	30–35	30–40	30–40	30–40	20–22	20–22	30–40
Flywheel	25–30	25–30	25–30	25–30	25–30	25–30	25–30	30–40	30–40	30–40	30–35	30–35	30–40
Starter device	2–3	2–3	2–3	2–3	2–3	2–3	2–3	3–4	3–4	3–4	2–3	2–3	2.5–4
Carburettor	3–4	3–4	3–4	3–4	3–4	3–4	3–4	4–6	4–6	4–6	1.5	1.5	5–6
Cylinder	10–12	10–12	10–12	10–12	10–12	10–12	10–12	8–10	8–10	8–10	8–10	8–10	10–12
Silencer	7–8	7–8	7–8	7–8	7–8	7–8	7–8	7–8	7–8	7–8	13–15	13–15	10–12
Crankcase	–	–	–	–	–	–	–	7–9	7–9	7–9	7–9	7–9	7–9
Decompression valve	–	–	–	–	–	–	–	–	–	–	–	12–14	12–14